

TECHMOUNT

Part # 21006 BMW R1200GS Fairing Mount

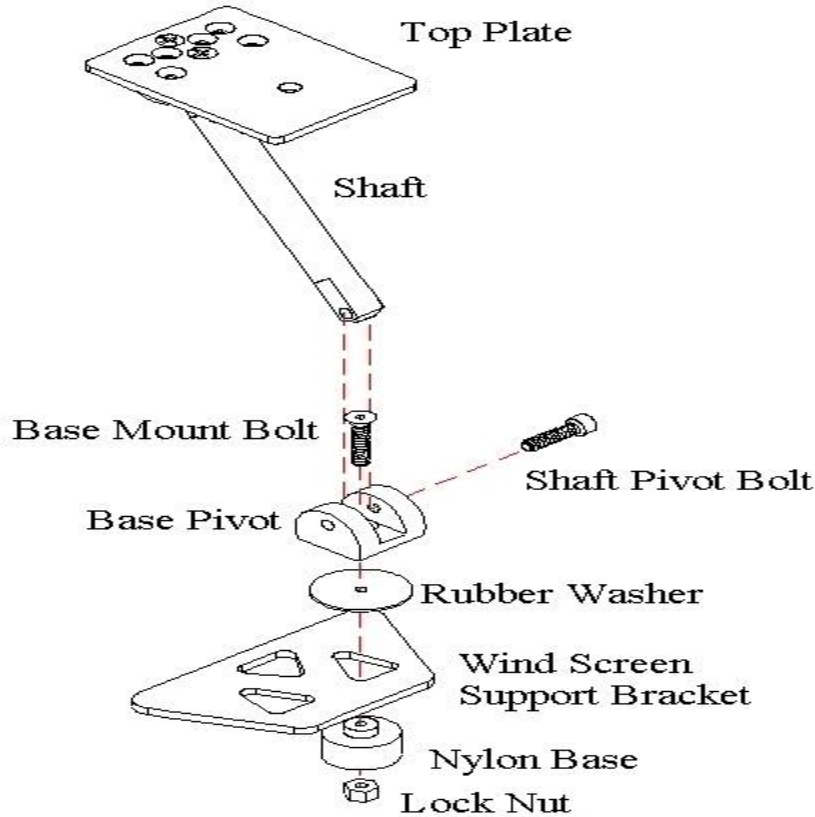

Instructions:

This mount system is designed to mount into one of the triangle shaped holes on the front fairing support just behind the windshield directly above the gauges on the BMW R1200GS. (Left or right side)

The mount is shipped fully assembled so it is necessary to remove the shaft from the mount base in order to access the mounting screw inside the base pivot.

1. Remove the 10-32 allen screw from the lower end of the mount with the supplied 5/32" allen wrench and remove the shaft and set aside.
2. Remove the nylock nut and lower black nylon spacer from the mounting base.
3. Place the small end of the spacer into one of the open holes in the front fairing support from the bottom. Now place the mounting base with the rubber washer on from the top with the bolt running thru the mounting base into the spacer. Now install the nylock nut from step 2.
4. Using the supplied 1/8" allen wrench tighten the mounting base screw so that the slot faces front to rear and re-install the shaft from step 1.
5. Adjust the shaft and top plate angle to suit and snug all the fasteners. The top plate has several sets of mounting holes to allow for different plate offsets. To offset the top plate simply remove the two #6 phillips head screw and align the plate as needed and re-install.
6. Peel the backing from the Velcro and attach to the top plate and your ready.

Note: To install a camera with a thumb screw use the 1/4" hole in the top plate.

